

2018: bladder cancer facts

2.7million

(ex)-bladder cancer patients

more than

340.000

will be diagnosed this year

over

160.000

will not survive



Non-muscle invasive bladder cancer has a

50%-80%

recurrence rate

Bladder cancer is the most expensive cancer from diagnosis to death as life long follow up is often necessary

Current diagnosis is not good enough!

Bladder cancer needs novel diagnostics and therapeutics to address its unmet needs

Scinvivo's forward looking OCT catheter

- Forward looking OCT imaging is enabled by a MEMS (micro-electro-mechanical system) mirror
- This MEMS mirror is patented by Scinvivo
- Fits in working channel of cystoscopes
- OCT enables early diagnosis by providing high resolution, sub surface images
- Scinvivo enables usage of OCT in hollow organs

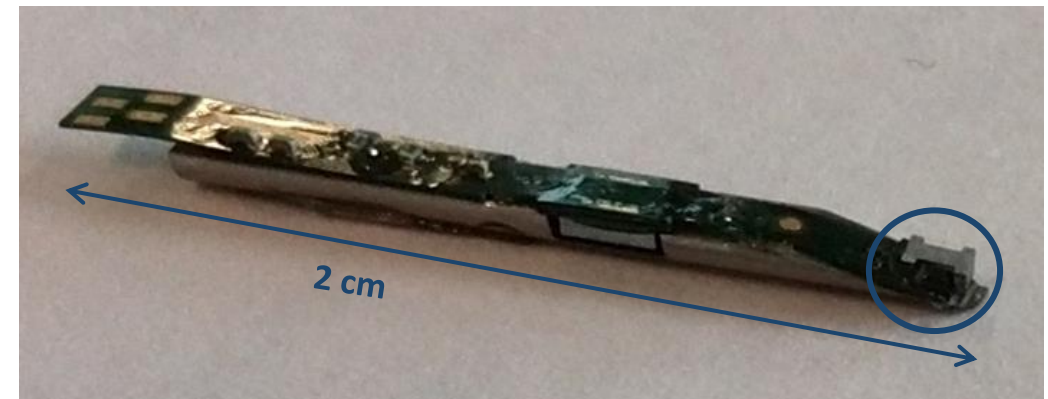
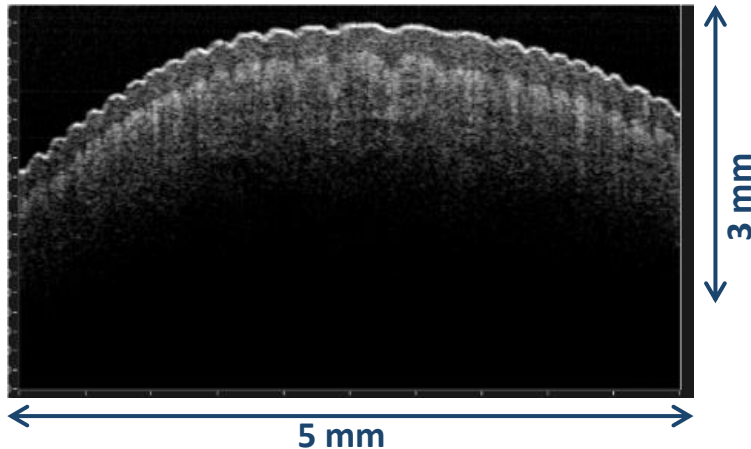

Scinvivo's patented MEMS mirror

What is Scinvivo looking for?

1. Current optical fiber assembly (SMF HI1060 + GRIN lens + microprism) is too expensive for high volumes. We are looking for different solutions for this, including fusion splicing of the fiber to the GRIN lens and using a mirror instead of a prism.

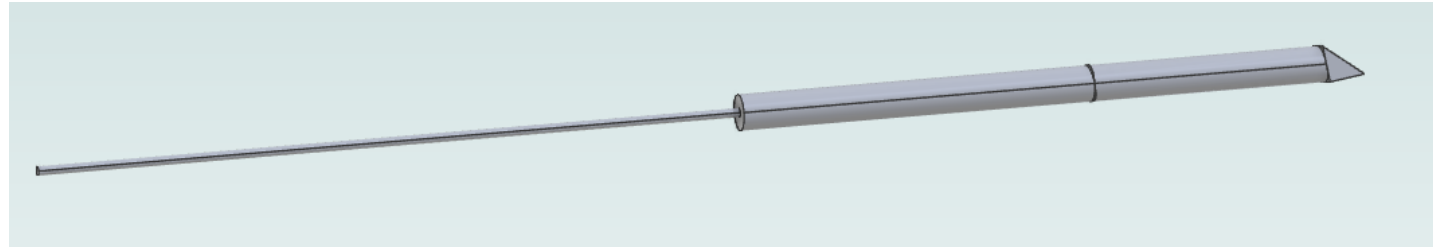

2. Scinvivo is developing a forward looking OCT-catheter, but does not want to develop the necessary OCT-system the catheter will connect to. Scinvivo needs a relatively fast OCT-system.



+

